

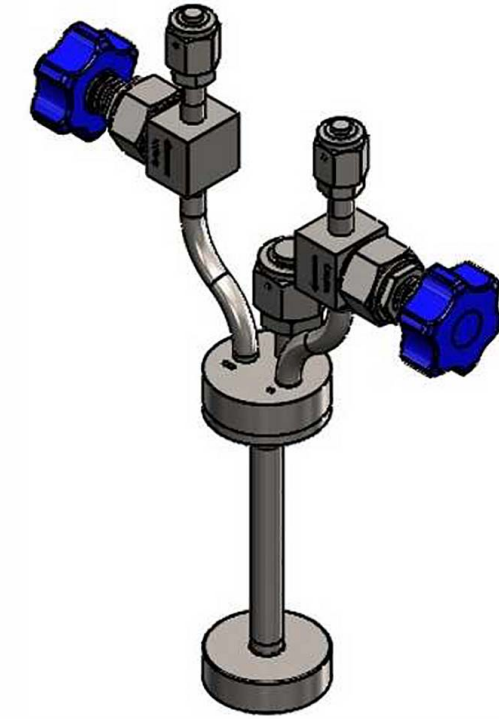

TECHNICAL NOTES: STREM ITEM NUMBER 97 - 7000

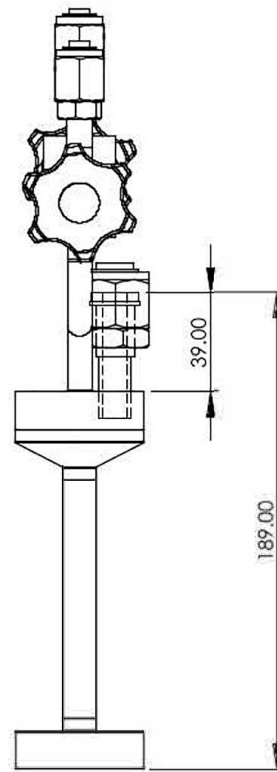
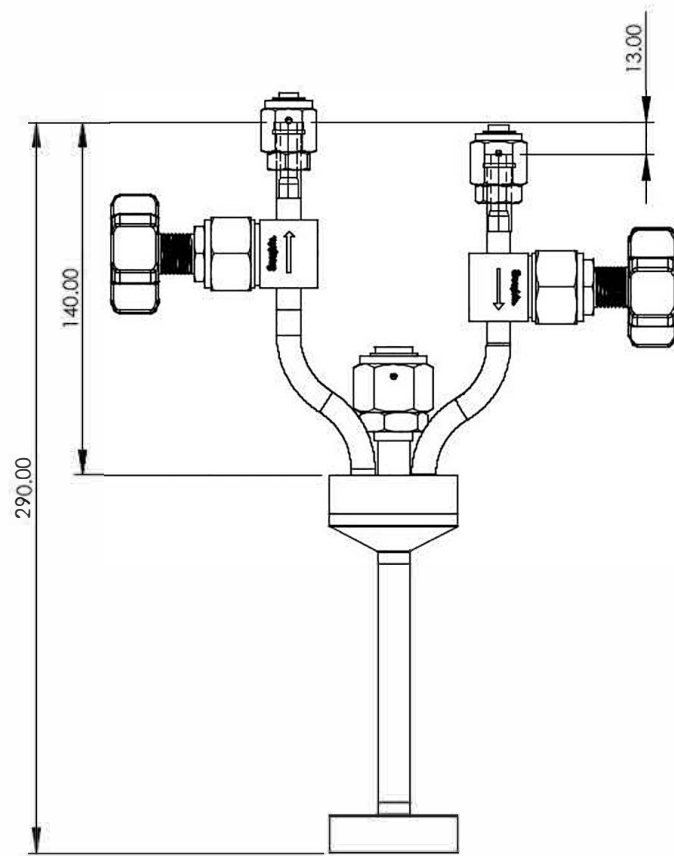
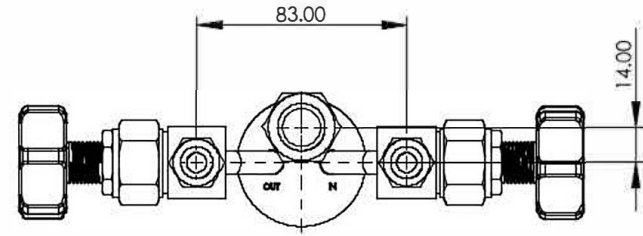

DESIGN SPECIFICATION	
CYLINDER MODEL	97 - 7000
CYLINDER SIZE	2" / 1/2"
CYLINDER WORKING VOLUME	7.00mL
CYLINDER TOTAL VOLUME	32.00mL
CYLINDER TARE WEIGHT	1735.00g
DESIGN PRESSURE	300
TEST PRESSURE	600
DESIGN TEMPERATURE	250F / 121C
INTERNAL FINISH	10 Ra ELECTRO POLISHED
EXTERNAL FINISH	10 Ra MIRROR POLISHED
FILLPORT	SS-8-VCR-3-8TA
INLET VALVE	6LV-DSBW6
OUTLET VALVE	6LV-DSBW6
THERMOWELL	NO
DIP TUBE	YES
MATERIAL OF CONSTRUCTION	316L SS
D.O.T SPECIFICATION	N/A
TOLERANCE (UNLESS STATED OTHERWISE)	+0.40

NOTICE OF CONFIDENTIAL INFORMATION

©COPYRIGHT 2019 STREM CHEMICALS, INC. ALL RIGHTS RESERVED

THIS IMAGE IS PROTECTED UNDER FEDERAL AND INTERNATIONAL COPYRIGHT LAW. NO PART OF THIS IMAGE MAY BE REPRODUCED, STORED OR TRANSMITTED IN ANY FORM BY ANY MEANS WITHOUT THE PRIOR WRITTEN CONSENT OF STREM CHEMICALS, INC. THIS IMAGE IS PROVIDED SOLELY AS A DEPICTION OF THE ITEM DESCRIBED. THERE IS NO RIGHT OR LICENSE GRANTED HEREIN TO CONSTRUCT THE ITEM DEPICTED IN THE IMAGE OR TO CREATE DERIVATIVE WORKS OF THE SAME WITHOUT THE PRIOR WRITTEN CONSENT OF STREM CHEMICALS, INC. ALL SUCH RIGHTS ARE EXPRESSLY RESERVED.